

C-125-148

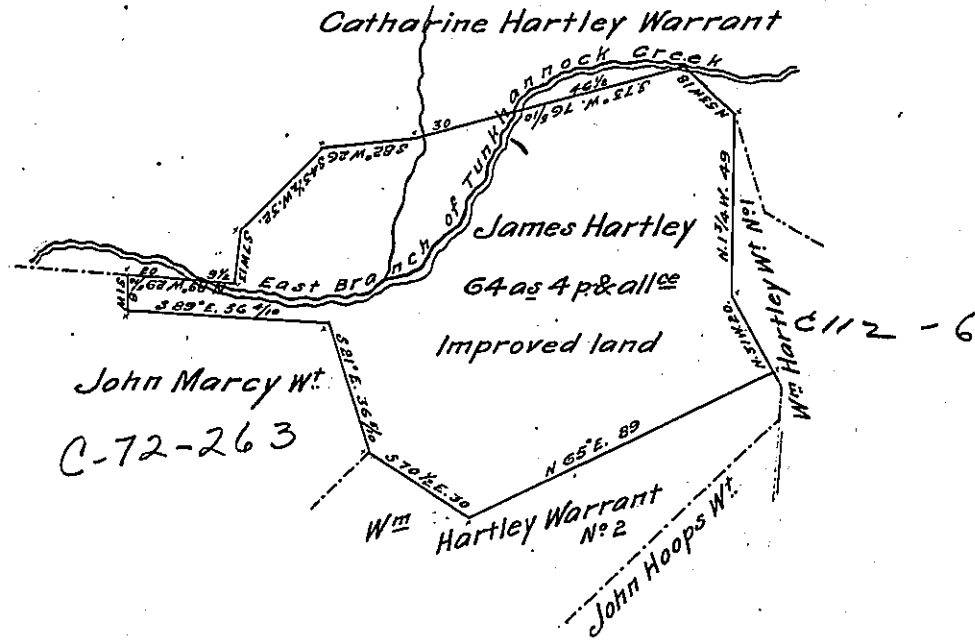

Draft of a tract of land <sup>Improved</sup> situate in Lenox township in the County of Susquehanna adjoining land in the Warrantee name of Catharine Hartley on the north, land of W<sup>m</sup> Hartley on the East, land of W<sup>m</sup> Hartley & John Marcy on the South & South West, and of John Marcy on the West, containing Sixty four acres & four perches and allowance of 6 per cent. Surveyed the 28<sup>th</sup> day of March A. D. 1870 for James Hartley in pursuance of a Warrant for Fifty acres dated the 24<sup>th</sup> day of November 1869

March 28, 1870.

James W. Chapman,  
County Surveyor.

IN TESTIMONY that the above is a copy of the original remaining on file in the Department of Internal Affairs of Pennsylvania, made conformably to an Act of Assembly approved the 16th day of February, 1833, I have hereunto set my Hand and caused the Seal of said Department to be affixed at Harrisburg, this

Seventh day of December 1905.

*Isaac B. Brown*  
Secretary of Internal Affairs.